

# me time<sup>®</sup>

MACHINE EMBROIDERY DELIVERED

Molly Zipper Pouch





## READY TO MAKE MORE PROJECTS LIKE THE MOLLY ZIPPER POUCH?

Join ME Time and stop wasting time and money hunting down project materials. ME Time delivers complete machine embroidery experiences right to your doorstep so you can start creating the moment you're ready!



### OUR SUBSCRIPTIONS

**PERFECTLY  
PIECED™**



#### MONTHLY SUBSCRIPTION

DOORSTEP SUBSCRIPTION	DIGITAL SUBSCRIPTION
\$49/month + shipping	\$19/month

**Collectible™**  
CHRISTMAS



#### MONTHLY SUBSCRIPTION

DOORSTEP SUBSCRIPTION	DIGITAL SUBSCRIPTION
\$24/month + shipping	\$10/month

**THE Bella BOX™**



#### TWICE-A-YEAR SUBSCRIPTION

DOORSTEP SUBSCRIPTION ONLY
\$115 + shipping

**JOIN ME TIME AND START CREATING TODAY!**

[METIMEDELIVERED.COM](http://METIMEDELIVERED.COM)

## Pattern Notes and Helpful Tips

### Using Kimberbell Products

#### Kimberbell Paper Tape

- We recommend taping all applique pieces in place to prevent shifting during the tack-down stitch.

### Notes

#### Mini Iron

- Use a mini iron or finger press along the seam lines. If you are using a mini iron, remove the hoop from the machine and press your project on an ironing board.

## Instruction Key

Each project will have a list of instructions to follow. These instructions include the following icons:

**1.** The **direction step** is found in the top corner of each photo.

 The **machine step** of the embroidery file (also found on your machine) is located in the box with the machine icon.

- Any **action item**, such as placing or trimming materials before the next step is stitched, is indicated by a bullet point.

 The **visible thread color icon** indicates that a contrasting thread color should be used, so the stitch is easily visible. These stitches will later be covered or removed.

 The **thread color box** indicates the color of thread that was used for the sample. These stitches will show in the end project.

 The **slashed color box** indicates a light thread color should be used. These stitches will not show in the end project.

 The **bobbin icon** indicates when the bobbin thread color needs to be changed.

 The **water-soluble bobbin icon** indicates when water-soluble thread should be used.

 The **presser foot** icon indicates when a sewing machine is used.

 The **iron icon** indicates that ironing is needed. Use the Pattern Notes and Helpful Tips section to determine the requirements for ironing various embellishments in your project.

 If the iron icon includes a green **pressing cloth**, be sure to use a pressing cloth when ironing.

 The **embroidery hoop icon** uses an arrow to indicate the top of the stitched design.

A **photo** of each machine step and action item depicts the instructions and shows how the steps are completed. When a photo shows fill, outline, or detail stitches, an arrow will point to those stitches.

## Embroidery Thread Colors

 **Note:** We matched our thread to our sample in these instructions. Your thread should coordinate with the fabric of your project.

## Example

**Direction Step**

4. **right side of glitter**

5. **Stitch the Cherry Tack-down Line.**

6. **Trim the glitter close to the stitch line.**

**Machine Step**

7. **Iron Icon**

8. **Stitch the Cherry Satin Outline.**

9. **Bobbin Icon**

**Action Item**

Using a pressing cloth, press the glitter with a warm iron for about 15-20 seconds to adhere the glitter to the fabric.

**Thread Color Box**

**Change the bobbin thread to match the top thread. Stitch the Cherry Stem Detail.**

**Note:** When fabric is placed in the hoop, a corner is folded back for illustration purposes only. Place your fabric completely flat.

**Note:** Stitching outlines on photos are shown for illustration purposes only and do not reflect the thread colors used to make the sample.



HOOP SIZE	5x7
MATERIALS	CUT SIZE
<b>FABRIC 1</b> •Below Zipper •Above Zipper	<b><u>1 Fat Sixteenth</u></b> <b>(1)</b> 3 x 7" <b>(1)</b> 1½ x 7"
<b>FABRIC 2</b> •Accent •Back	<b><u>1 Fat Sixteenth</u></b> <b>(1)</b> 2 x 7" <b>(1)</b> 5 x 7"
<b>FABRIC 3</b> •Below Zipper Lining •Above Zipper Lining •Back Lining	<b><u>1 Fat Sixteenth</u></b> <b>(1)</b> 4½ x 7" <b>(1)</b> 1½ x 7" <b>(1)</b> 5 x 7"
KIMBERBELL® PRODUCTS	
<b>Kimberbell Project Batting (KDST138)</b>	<b>(2)</b> 5 x 7"
<b>Medium Cut-Away Stabilizer (KDST114-116)</b>	
<b>PAPER TAPE (KDTL100)</b>	
ADDITIONAL MATERIALS	
•Nylon Coil Zipper •Fabric Starch •Needle and Thread	<b>(1)</b> 8"

A Fabric Scrap is 5 x 5" A Fat Sixteenth is 9 x 11"  
 A Fat Eighth is 9 x 21" A Fat Quarter is 18 x 21"

## 5x7 Design

**FILE:** 5x7-molly-zipper-pouch

**EMBROIDERY FIELD:** 4.30 x 6.40" or 109.2 x 162.6 mm

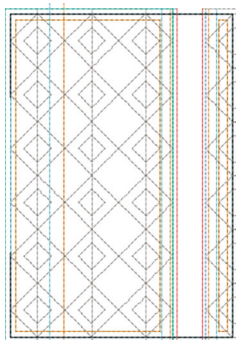

**FINISHED SIZE:** 4 x 6"

## (2) PART PROJECT

This project is completed in **(2)** parts.

**Part 1** is preparing the fabric before embroidery.

**Part 2** is piecing and finishing the zipper pouch in the hoop.

**Note:** Use only nylon coil zippers for this project. You will be sewing across the teeth of the zipper. Nylon coil zippers are suitable for this purpose. Sewing across other types of zippers may damage your machine.







## Part 1: Preparing the Fabric Before Embroidery

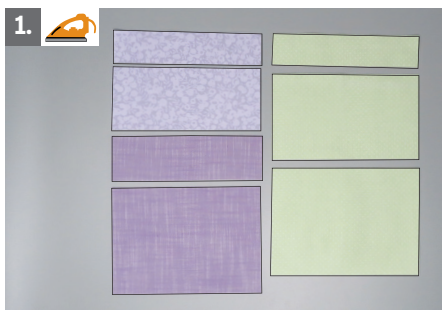

- Using your favorite fabric starch, starch each of the fabric pieces and press well.

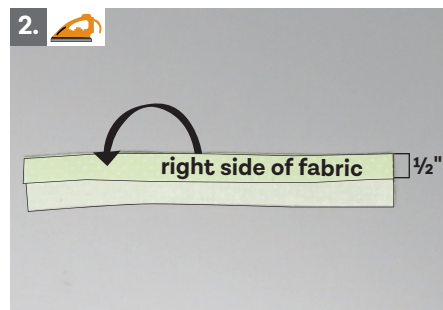

- Fold the Above Zipper Lining Fabric down  $\frac{1}{2}$ " on **(1)** long edge, **wrong sides together**. Press well.



- Fold the Below Zipper Lining Fabric down  $\frac{1}{2}$ " on **(1)** long edge, **wrong sides together**. Press well.

## Part 2: Piecing and Finishing the Zipper Pouch in the Hoop



- Hoop **(1)** layer of **Medium Cut-Away Stabilizer**.

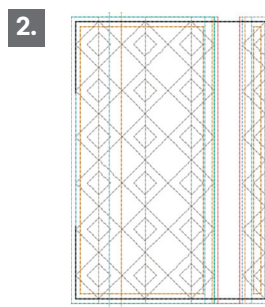

- Load the Molly Zipper Pouch embroidery file into the machine.

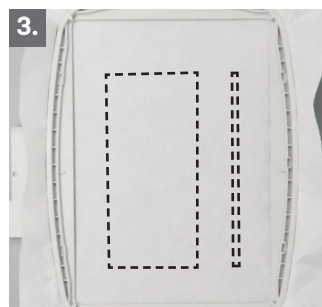

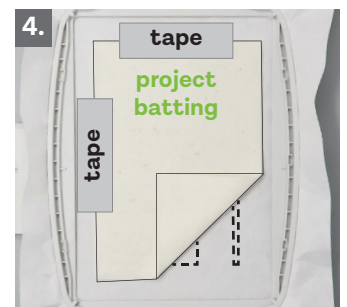

- Stitch the Batting Placement Lines.



- Place **(1)** **Project Batting**, covering the placement lines.

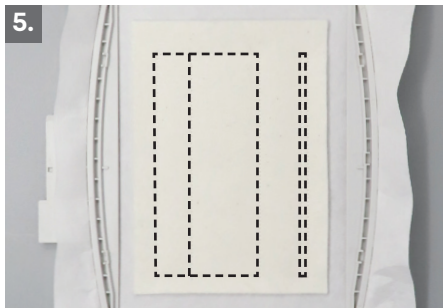



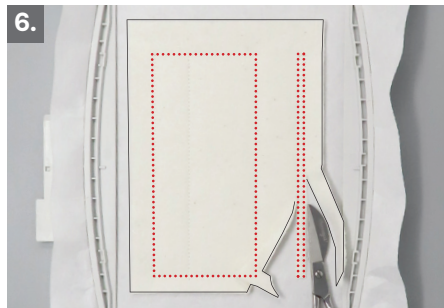

**5.**  
 Stitch the Batting Tack-down Lines and Piecing Boxes Template.

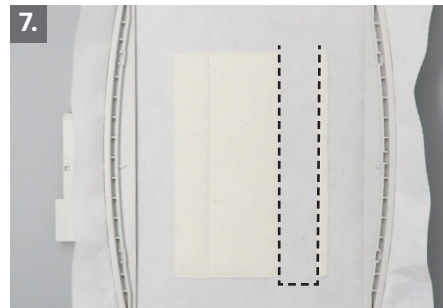

**6.**  
 • Trim the batting close to the stitch lines around **both** of the piecing boxes (shown in **red**).



**7.**  
 **3** Stitch the Zipper Placement Line.

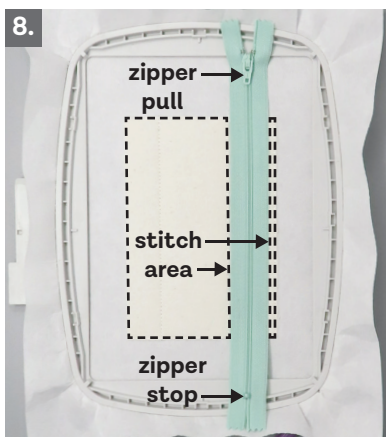

**8.**  
 • Center the nylon coil zipper, **right side up**, inside the zipper placement area, with the zipper pull to the **top** of the hoop. Be sure that the zipper pull and the zipper stop are outside the stitch area.

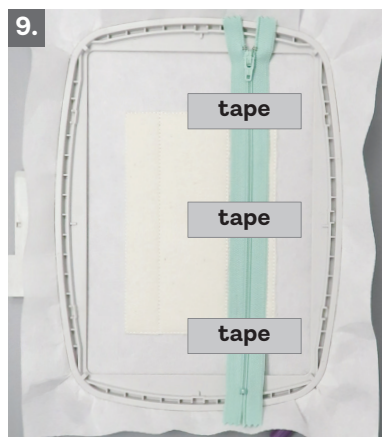

**9.**  
 • Tape the zipper in place. Place the tape over the zipper teeth as shown.

**Note:** The tape placed at each end of the batting will help the presser foot glide over the zipper teeth when stitching.



**10.**  
**Note:** You may need to raise the presser foot to stitch over the zipper.

 **4** Stitch the Zipper Tack-down Line.

• Remove the tape.

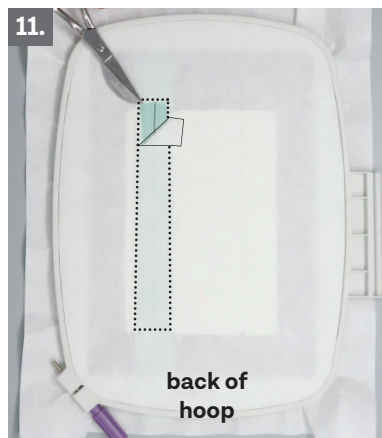

**11.**  
 • Remove the hoop from the machine. Turn the hoop to the **back**. Carefully cut away the stabilizer from inside the zipper placement area stitched in **Direction Step 7**.

**Note:** This will expose the back of the zipper.

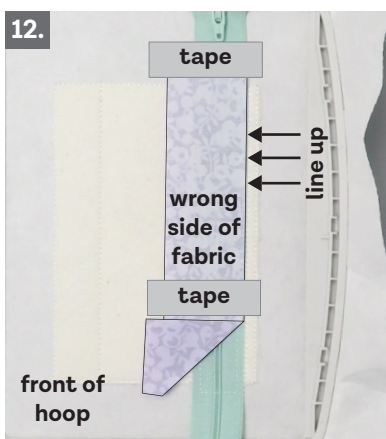

**12.**  
 • Turn the hoop to the **front**. Place the Above Zipper Fabric, **right side down**, with **(1)** long edge of the fabric aligned with the **right** edge of the zipper tape. The fabric should lay centered over the zipper, with the excess fabric to the **left**. Tape in place.



**13.**  
 **5** Stitch the Above Zipper Seam Line.  
 • Remove the tape.



14. 

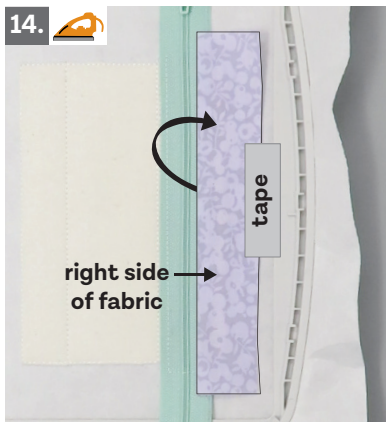

• Flip the fabric **right side up**, and press. Tape in place.

• **Note:** Use a mini iron or finger press along the seam line. If you are using a mini iron, remove the hoop from the machine and press your project on an ironing board or mat.

15.

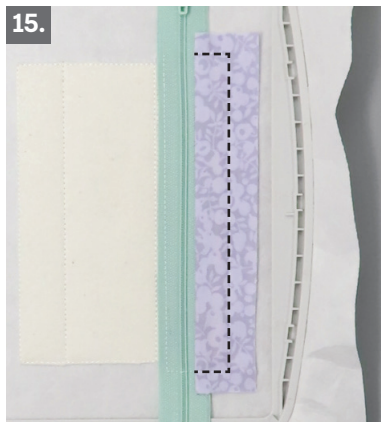

6 Stitch the Above Zipper Tack-down Line.

• Remove the tape.

16.

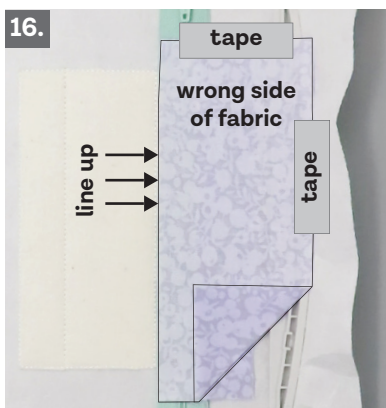

• Place the Below Zipper Fabric, **right side down**, with (1) long edge of the fabric aligned with the **left** edge of the zipper tape. The fabric should lay centered over the zipper, with the excess fabric to the **right**. Tape in place.

17.



7 Stitch the Below Zipper Seam Line.

• Remove the tape.

18. 

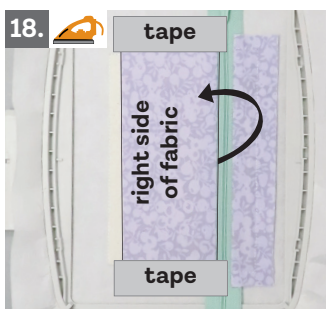

• Flip the fabric **right side up**, and press. Tape in place.

19.



8 Stitch the Accent Placement Line.

20.



• Trim any excess fabric to the left of the stitch line. Cut close to the stitch line without clipping any stitches.

21.

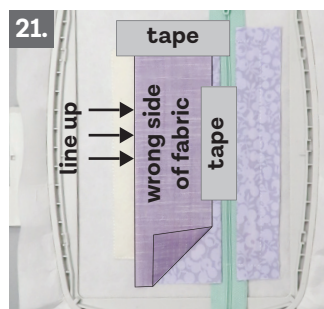

• Line up and center the Accent Fabric, **right side down**, with the placement line. Excess fabric will be to the **right**. Tape in place.

22.

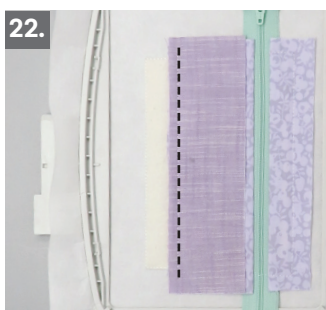

9 Stitch the Accent Fabric Tack-down Line.

• Remove the tape.

23. 

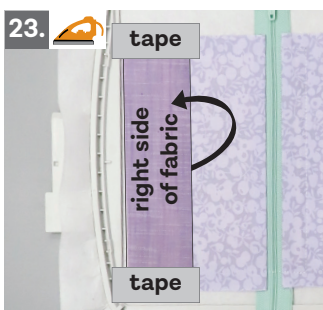

• Flip the fabric **right side up**, and press. Tape in place.

24.

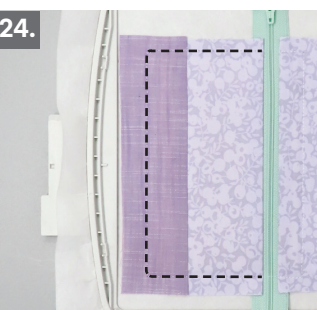

10 Stitch the Below Zipper Tack-down Line.

• Remove the tape.

25.

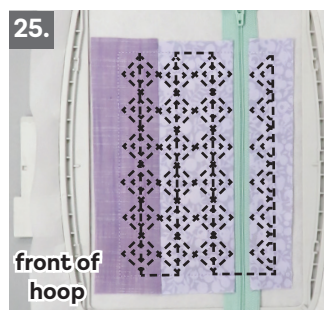

11 Stitch the Quilting Detail.



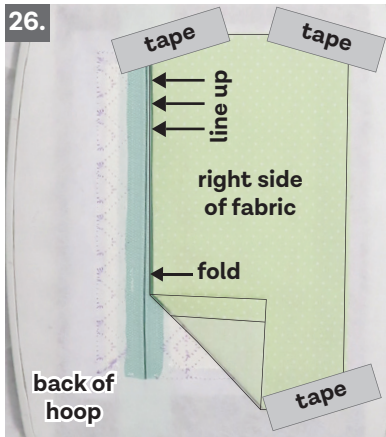

- Remove the hoop from the machine. Turn the hoop to the **back**. Place the Below Zipper Lining Fabric, **right side up**, with the folded edge aligned just to the right of the zipper teeth. Tape all four corners in place.

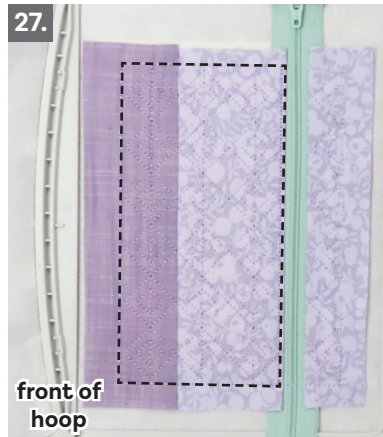

- Turn the hoop to the front.



**12** Stitch the Below Zipper Lining Tack-down Line.

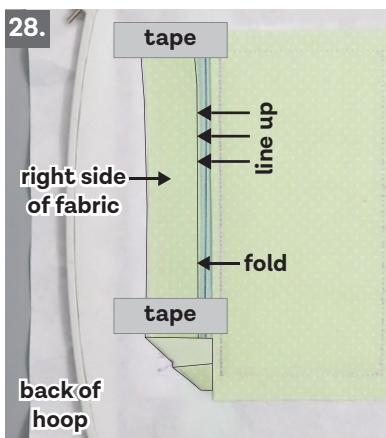

- Remove the hoop from the machine. Turn the hoop to the **back**. Place the Above Zipper Lining Fabric, **right side up**, with the folded edge aligned with the zipper teeth. Tape all four corners.



- Turn the hoop to the front.



**13** Stitch the Above Zipper Lining Tack-down Line.

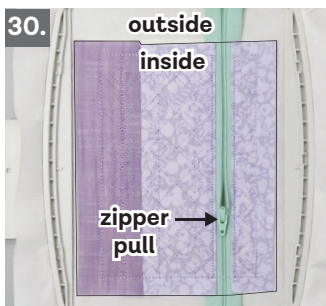

- Open the zipper  $\frac{3}{4}$  of the way, placing the zipper pull **inside** the project.

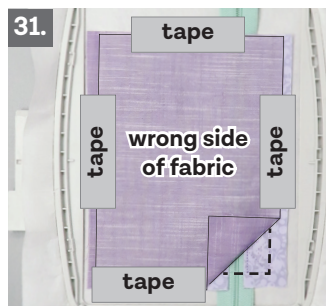

- Place the Back Fabric, **right side down**, completely covering the **front** of the project. Tape in place.

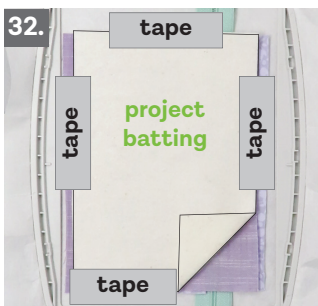

- Place the remaining **(1) Project Batting on top** of the Back Fabric, covering the project. Tape in place as shown.

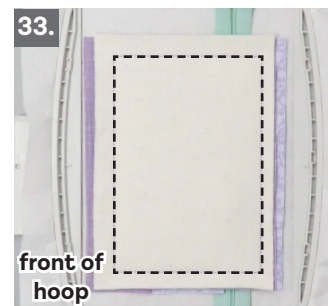

**14** Stitch the Back Tack-down Line.

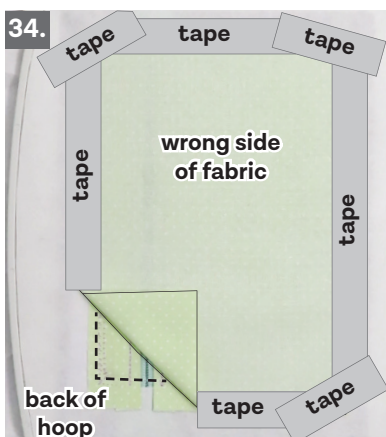

- Remove the hoop from the machine. Turn the hoop to the **back**. Remove the tape.
- Place the Back Lining Fabric, **right side down**, covering the project. Tape the corners and sides well, as shown.

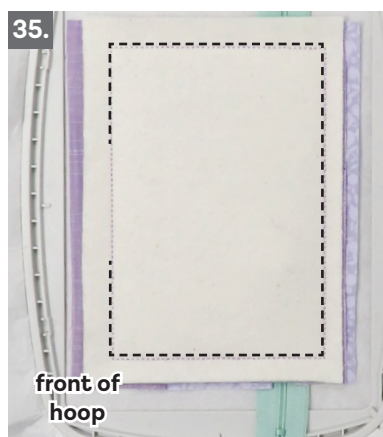

**15** Stitch the Final Outline Stitch. **Note:** This stitch leaves an opening to turn the lining **right side out**.



36.



- Remove the project from the hoop.
- Remove all of the tape from the project.

37.

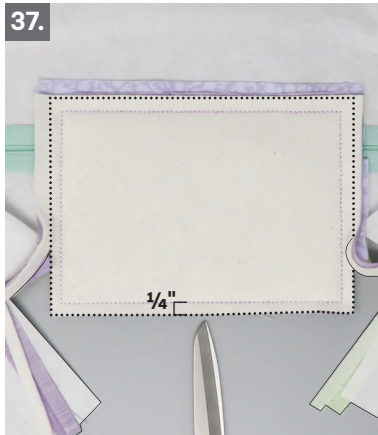

- Trim around the entire project, including the zipper, leaving  $\frac{1}{4}$ " seam allowance.

38.

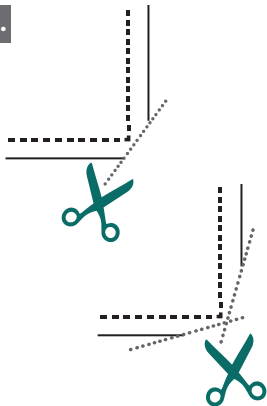

- Clip the corners to reduce bulk.
- Trim across the corner seam allowance, being careful not to cut through the stitches.
- Trim again at a slight angle, from the corner up the seam allowance, about 1" on each side.

39.



- Carefully turn the project through the opening in the lining to expose the inside of the pouch.
- Carefully poke all four corners with a blunt tip to square.

40.

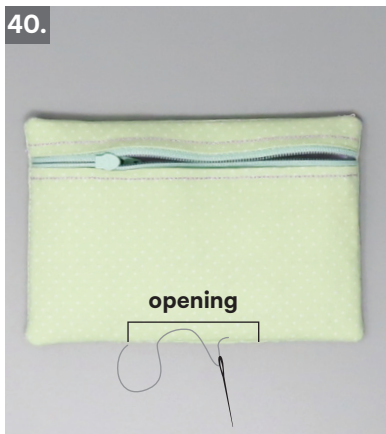

- Fold in the raw edges of the lining opening to give it a finished look. Using a needle and thread, stitch the opening closed.

41.



- Turn the pouch right side out.

42.



- Carefully poke all four corners with a blunt tip to square.

43.



- Press with steam.
- **Optional:** Spray the edges of the pouch with fabric starch and press well.